

# Adapts to every provider, adopted by every department

The future of healthcare isn't about replacing doctors. It's about removing barriers that limit access to quality care.

When AI works how providers think, transformation just happens—turning documentation burden into a capacity multiplier.

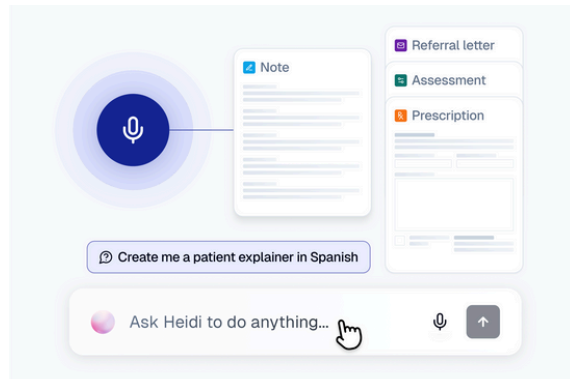

## Stop losing providers to burnout

Heidi adapts to how providers work—they speak naturally during care, get structured clinical notes instantly, with zero cleanup after. When tools help instead of adding steps, providers stay focused on patients, not admin.

**65%+** adoption in the first month

## Turn documentation time into patient time

Every minute spent on notes is a minute not spent with patients. Heidi handles real-time transcription, documentation, coding, and follow-up tasks while providers stay fully present during encounters.

**6 minutes** saved per encounter

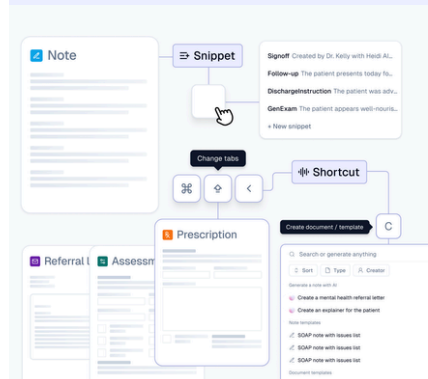
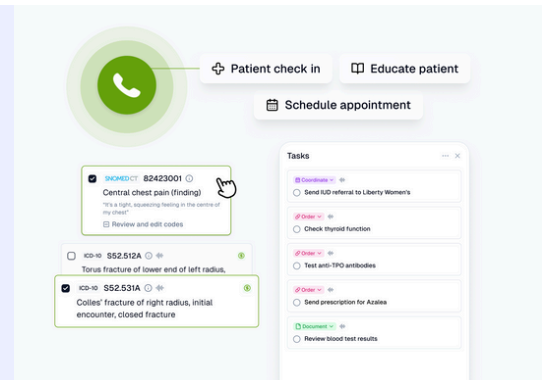

## One platform that grows with every department

From emergency to psychiatry, pediatrics to oncology—Heidi understands clinical language across specialties. Your providers move seamlessly between departments without learning new systems or losing momentum.

**200+** specialties deployed

"I'm an EM physician, and using Heidi for the last three weeks has been game changing for my workflow. It's cut down on 90% of my documentation time—I only have to change about 5% of the generated note. The biggest change has been going to see patients one after the other without having to go back to my desktop to document."

Provider, Emergency Medicine

## Trusted in 2 million patient visits each week



# How Heidi works

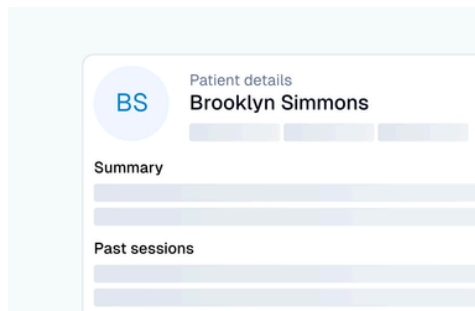

## Before encounter

Pull patient history, review past sessions, sync schedules. Upload reports so Heidi has complete context.

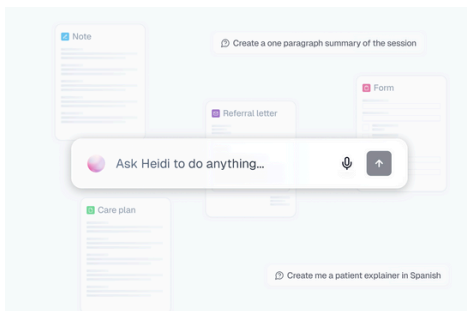

## During consult

Hit record and focus on your patient. Heidi captures everything in 110+ languages, creating structured SOAP, H&P, or custom notes.

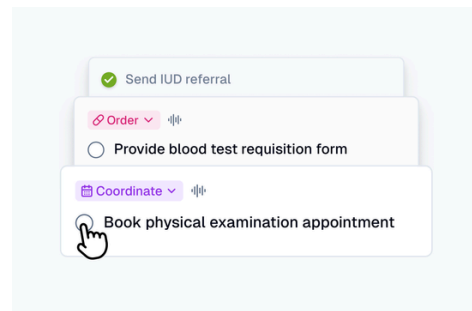

## After consult

One click pushes documentation to your EHR. Auto-applies ICD-10 codes, generates follow-ups, referrals, and discharge summaries.

## Why healthcare leaders choose Heidi



Healthcare organizations using Heidi get back on average 10 hours per provider each week.

Scan to find out how much you could save.

## Works how providers do

- Adapts to each provider's style with tailored templates and terminology
- Integrates with EHR systems including Epic, Cerner, and Veradigm
- Works across diverse patient populations with 110+ languages
- Flexible across every setting with desktop and mobile

## Immediate impact you can measure

- 6 minutes saved per encounter—translating to 2+ hours daily per provider
- 90% reduction in clinical documentation time within sessions
- 65%+ adoption in first month across departments
- 200+ specialties successfully deployed globally

## Enterprise-ready from day one

- SOC-2, HIPAA, and ISO compliance with data sovereignty
- 99.9% uptime with redundant infrastructure
- No connectivity dependencies with offline
- 24/7 support with dedicated Customer Success management

## Give your providers their time back

[heidihealth.com/enterprise](https://heidihealth.com/enterprise)  
[enterprise@heidihealth.com](mailto:enterprise@heidihealth.com)

## Start with a pilot

- Dedicated implementation support
- Pilot program design based on your goals
- Usage analytics to track ROI from day one
- Department-by-department roll out at your pace

Trusted by thousands  
of teams globally

