

# SPIROBANK Oxi

## Patient

### Quick Reference Guide

#### Intended Use

The Spirobank Oxi Spirometer and Pulse Oximeter is intended to be used by a physician or by a patient under the prescribed use of a physician. The equipment is intended to test lung function and can perform tests in adult and paediatric patients greater than 5 years. When used as Oximeter, the Spirobank Oxi is intended for spot-checking of functional oxygen saturation of arterial haemoglobin (SpO<sub>2</sub>) and Pulse Rate (PR) from the patient finger. The Spirobank Oxi has been designed for use in the physician's office, in hospital, or directly by the patient to monitor her/his physical conditions at home.



#### Warnings:

*Note: a more complete listing of warnings are found in the Instructions for use.*

**The disposable turbine is made of plastic with paper mouthpiece and its disposal after use should adhere to the local regulations and norms in force.**

**The accuracy of the reusable turbine can only be guaranteed if it has been cleaned in the correct manner and is free from foreign bodies. Weekly cleaning should only be done when the equipment is for personal use and will only be used by one patient. The cleaning of the turbine should be performed according to the instructions contained in this User's Manual.**

**If the Pulse Oximetry sensor appears damaged, do not use it. Use other equipment, or contact your authorized repair center for assistance**

# Welcome

Your doctor has prescribed the SPIROBANK Oxi for your home use. The tests you complete will help you and your doctor see how well your lungs work.

## We are here to help

If you have any difficulty completing a test, call your doctor for assistance.

If the SPIROBANK OXI does not work properly, call our help line at  
1-262-565-6797

## How it works

### Do a test



### View data



### Send report to doctor



Note: Refer the SPIROBANK Oxi manual for more complete information

# Let's get started

## *Preparing your SPIROBANK Oxi*

Your SPIROBANK Oxi comes already assembled. All you need to do is install the batteries

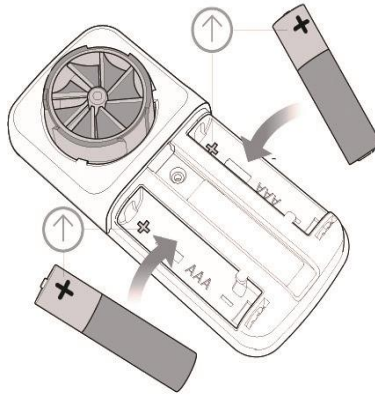

## *Download the SPIROBANK App*

Select  
camera app



Take picture of QR  
code



Download  
app

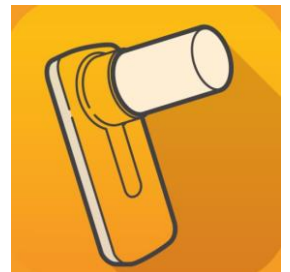

## Enter your information

11:36

Welcome

**Patient ID**  
Patient ID

**Name**  
Name

**Last name**  
Last name

**Date of Birth \***  
Date of Birth

**Origin**  
Origin

**Weight \*** **Height \***  
Weight Height

**Gender \***  
Gender

\* Mandatory fields

Proceed

## Connect to SPIROBANK Oxi

11:37

Searching for devices

Searching for device:  
Research terminated

Available devices

SPIROBANK SMART Z016133 **CONNECT**

SPIROBANK OXI E000049 **CONNECT**

SPIROBANK SMART Z000011 **CONNECT**

Start a new search

## Let's do a test

### Breathing test

Test is best done while standing or sitting still.

### Select the test

16:52

Test

Connected to:  
SPIROBANK OXI | E000028

**FVC Spirometry**  
Start the test

**SVC Spirometry**  
Start the test

**Oximetry**  
Start the test

**Live Video Exam**  
Start the call

Test Results Profile

### Blow correctly

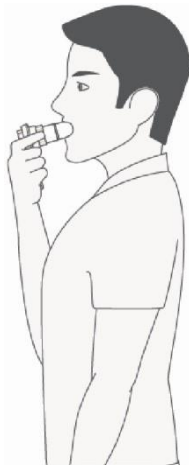

### Flow bars appear during test

17:35

Spirometry Test

YOUR TARGET YOUR RESULT

Trial underway - blow harder

Stop trial

### Test results

11:41

Results

BEST PARAMETERS

5.84 L FVC

5 FEV1

789 L/min PEF

5.83 L FEV6

6.88 L/s FEF2575

85.62 % FEV1/FVC

Curves

Trials Symptoms Notes

11:41:38 Acceptable trial

FVC	FEV1	FEV6	FEV1/FVC	FEF2575	PEF
5.84	5	5.83	86	6.88	789

11:40:38 Acceptable trial

FVC	FEV1	FEV6	FEV1/FVC	FEF2575	PEF
4	2.24	3.69	56	0.97	340

## Oxygen Saturation test

Test is best done while sitting and not moving. This test will not work if there is too much motion

Select the  
oximetry test

Put the finger  
correctly to  
the sensor

Saturation curve, SpO2  
and Heart rate values  
appears in real-time...  
just wait...

Test results

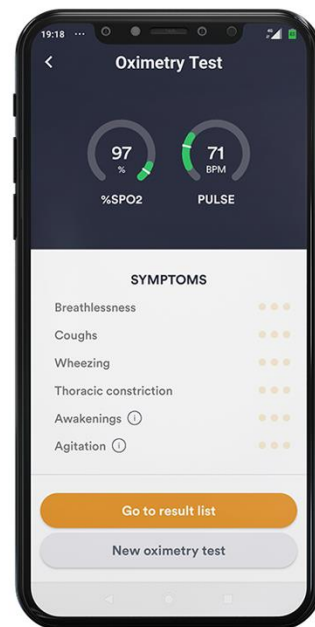
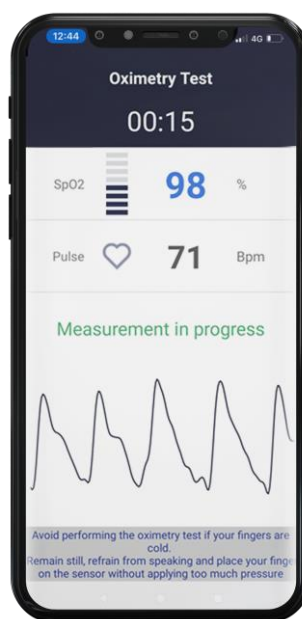
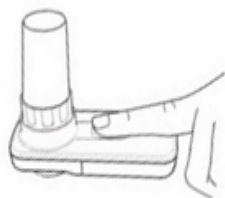
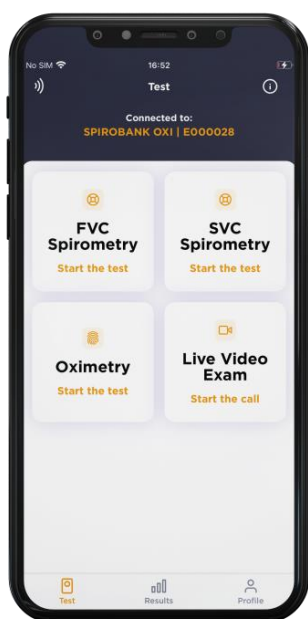

## Entering Symptoms

It will be helpful to your doctor to know how you feel. You can select from a list



# Using your data

## Select a result

Go to results list

List of results

See a set of results

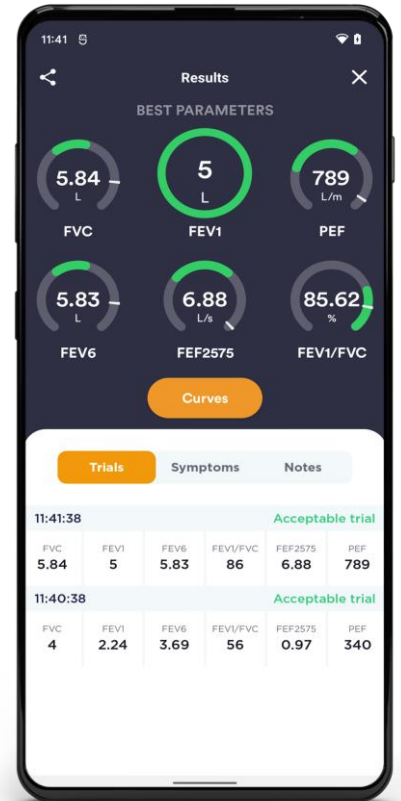
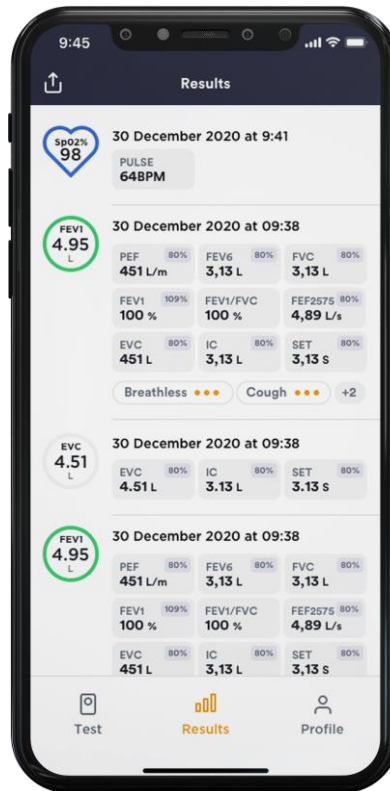
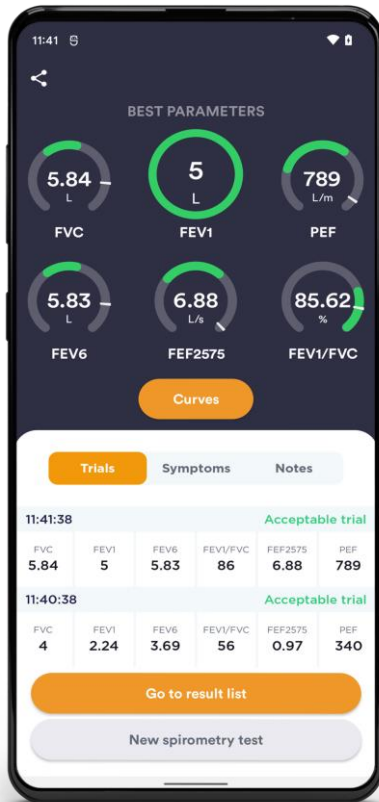

Note: Refer to the SPIROBANK Oxi manual for more information about the measurements

## *Sending a result to your doctor*

You can send a report to your doctor from you Smartphone

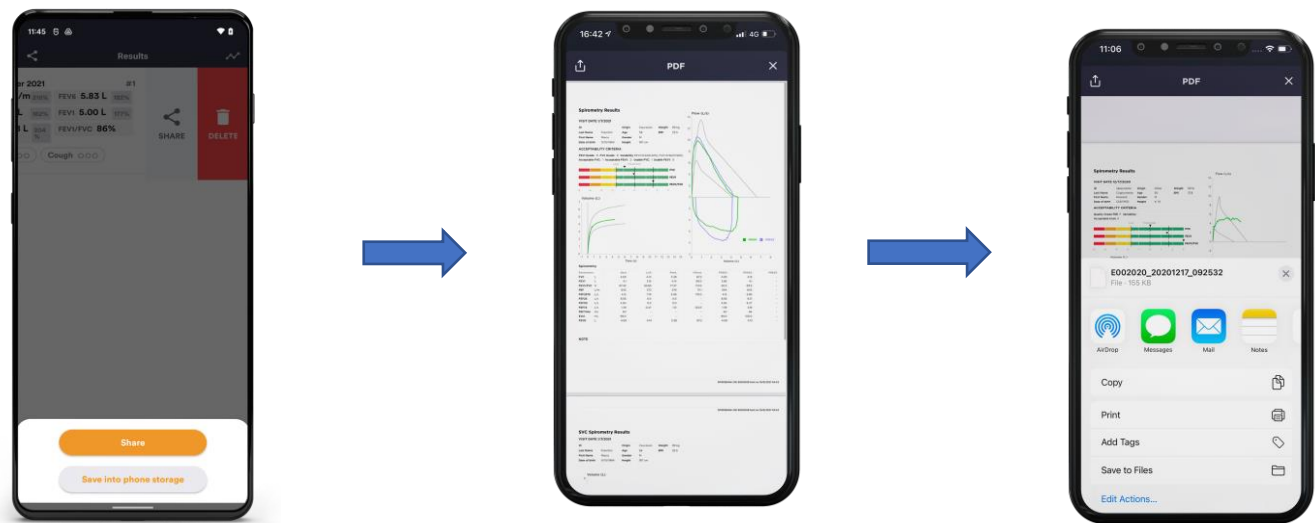

## *Cleaning and Disinfecting*

1. Rotate the turbine and mouthpiece counterclockwise to separate it from the handheld unit

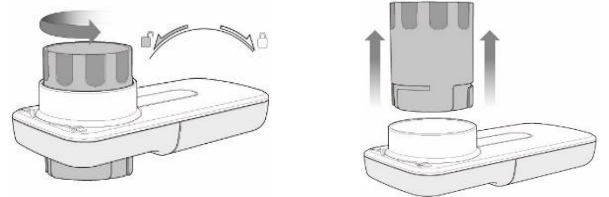

2. Wash the turbine and mouthpiece in warm water with a mild dish detergent.

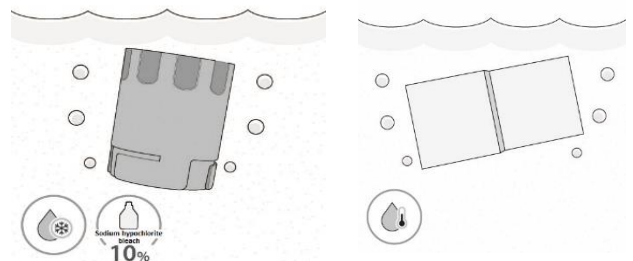

Warning. Do not place turbine in running water. It may damage the unit.

**3. Mix ¼ cup of Clorox™ bleach in one quart of water. Place turbine and mouthpiece in solution mixture for 5 minutes.**

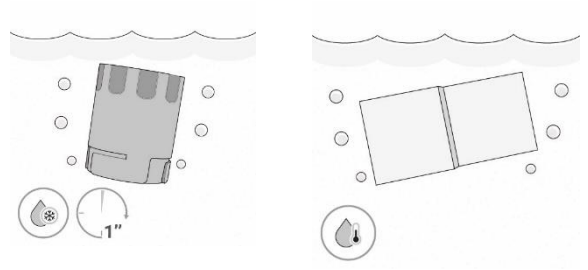

**4. Rinse turbine and mouthpiece in clean water for 1 minute.**

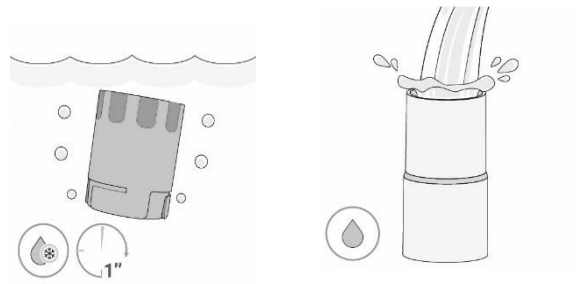

Clean and disinfect the electronic unit with a damp cloth from the same Clorox dilution. **DO NOT SUBMERGE THE DEVICE.** Let the device dry, then clean the device with a warm damp cloth.

List of Cautions:

A complete set of cautions are found in the SPIROBANK Oxi manual

Icons:

A complete set of ICONS are found in the SPIROBANK Oxi manual